

# 1. Position and secure with tape

- Your surface needs to be clean before you install the lettering.
- Double check that it is level and in the correct location.



## 2. Remove the liner

- The lettering is very sticky, be careful!

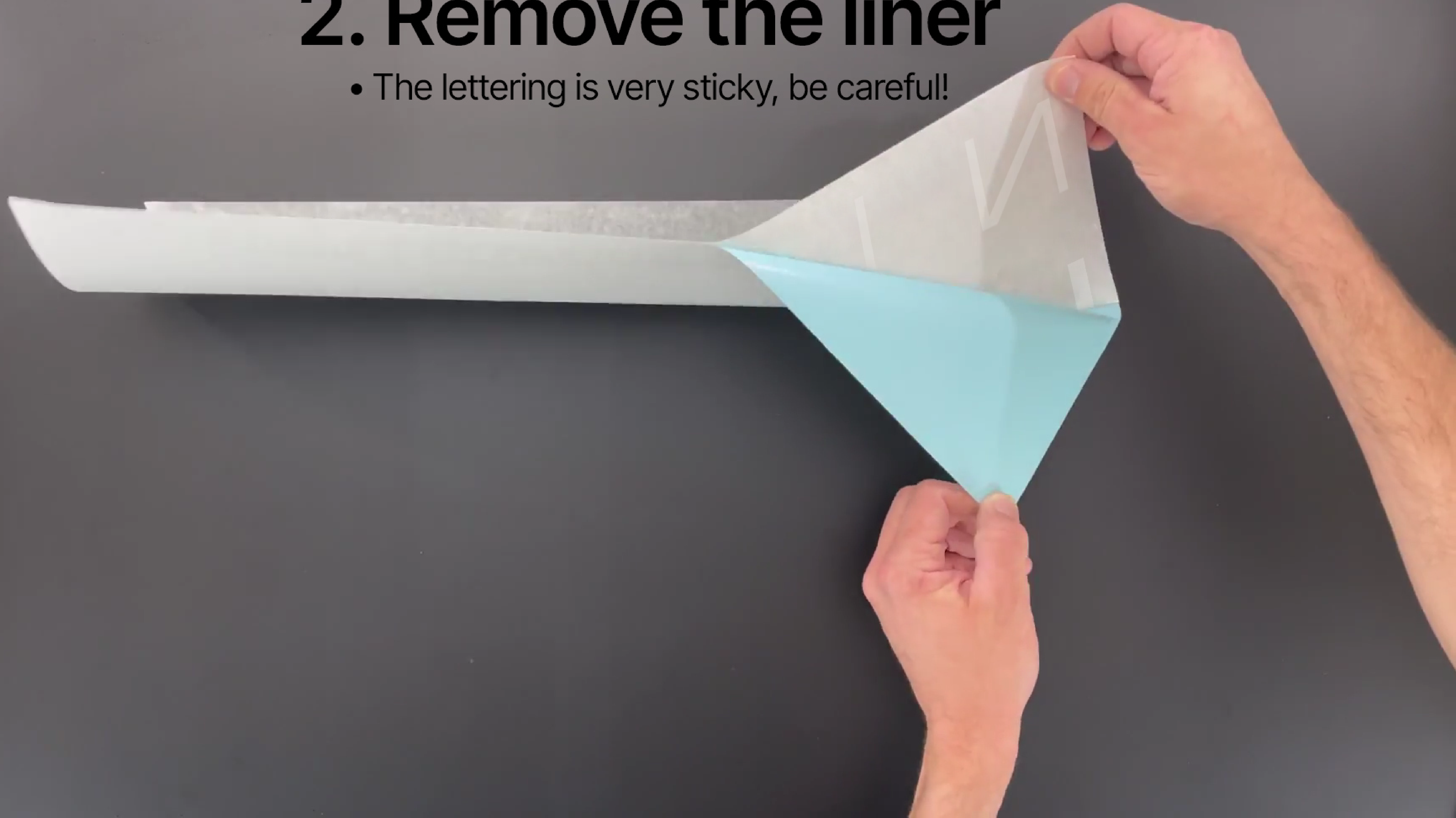

### 3. Apply the lettering

- Keep the lettering taut with the tape that's holding it in place.
- Start from the taped edge, and work towards the other edge.





## 4. Remove the transfer tape

- Make sure the lettering is firmly pressed onto your surface before you remove the tape.





THE  
CUSTOM  
CAPTAIN

